



\$18,000

• Active

00000 NW 316TH ST OKEECHOBEE, OKEECHOBEE, FL, 34972

<https://comwire.com>

2.5 Acres of Off-Road Fun in Okeechobee! Bring your ATVs, dirt bikes, and outdoor toys—this recreational lot is your off-grid escape! Located about 1.15 miles off NW 316th St near Kissimmee Prairie Preserve. Great for camping, hunting, trail riding, and weekend adventures. Not buildable, no fencing allowed. Flood Zone X - no wetlands. Buyer to verify

[+ Read More](#)

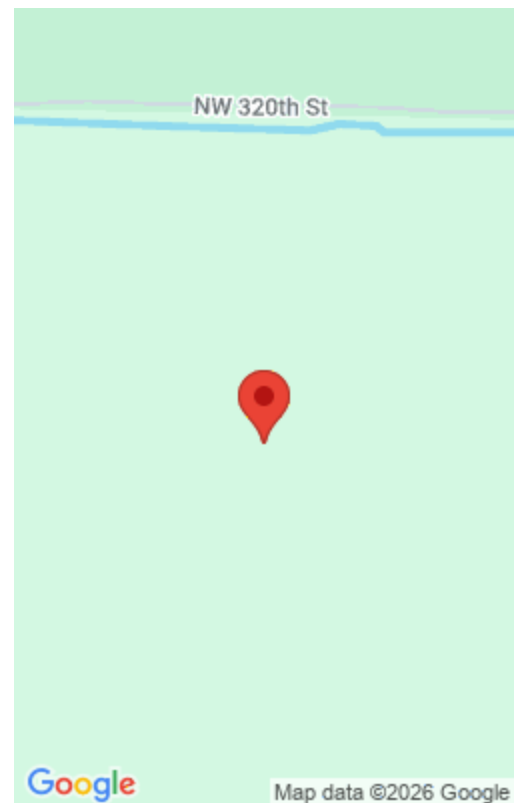

Basics



Comwire last checked: 12:22 pm on April 03, 2026

Listing updated: February 04, 2026 at 8:13 pm

Days on Comwire: 449

Status: Active

Listing Office Id: 276577440

Date added: April 16, 2025 at 4:57 pm

Lot size: 2.50 sq ft

Est. Taxes: \$242.63

Price/Acre: \$7,200

For Sale: No

For Lease: No

Listing Office Name: Platinum Preferred Realty LLC

Site Details

Acres: 2.50

Lot SqFt: 108900.00

Improvements: None

Utilities On Site: None

Front Exp: North

Lot Description: 1 to < 2 Acres,2 to < 3 Acres

Roads: Dirt,No Access Road

Ground Cover: Grassed,Other

Building Details

Type: Agricultural

Docs Available: Appraisal

Additional Info

Listing Agent Phone: (561) 303-4562

Listing Office: Platinum Preferred Realty LLC

MLS Source: Realtor Association of the Palm Beaches (RAPB)

