



\$24,900

• Active

**16816 NW 314TH ST, OKEECHOBEE, FL
34972, USA**

<https://comwire.com>

Owner Financing Available. Build or bring your dream home and barn on this beautiful private 1.25-acre corner lot that is high and dry. 15218 NW 316th is also available, offering the potential to expand to 3.75 acres. Located just off the main paved road, yet still private. This street has power poles, making electricity easily [+ Read More](#)

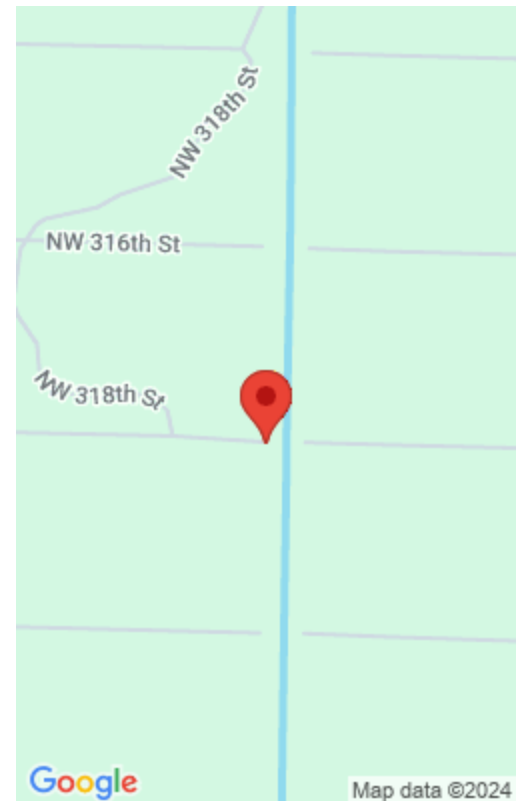

Basics



Status: Active

Date added: Added 2 months ago

Est. Taxes: \$467.41

For Sale: No

Listing Office Name: American Realty of PSL LLC

Listing Office Id: 276736100

Lot size: 1.25 sq ft

Price/Acre: \$19,920

For Lease: No

Site Details

Acres: 1.25

Improvements: None

Front Exp: East

Roads: Dirt

Lot SqFt: 54450.00

Utilities On Site: None

Lot Description: 1 to < 2 Acres

Ground Cover: Other

Building Details

Type: Single Family Detached

Docs Available: None

Additional Info

Listing Agent Phone: (772) 200-5418

Listing Office: American Realty
of PSL LLC

MLS Source: Realtor Association of the Palm Beaches (RAPB)

