



**\$70,000**

• Active

**15270 252ND STREET, OKEECHOBEE, FL,  
34972**

<https://comwire.com>

Ready to Build your dream home on this 1.25 acre lot in Viking Estates also know as the Prairie. Well fenced with electric and clean well water, it is approximately 30 minutes from the heart of Okeechobee and just east of the Kissimmee River Preserve State Park. Come enjoy hunting, fishing, or just the quietness

[+ Read More](#)

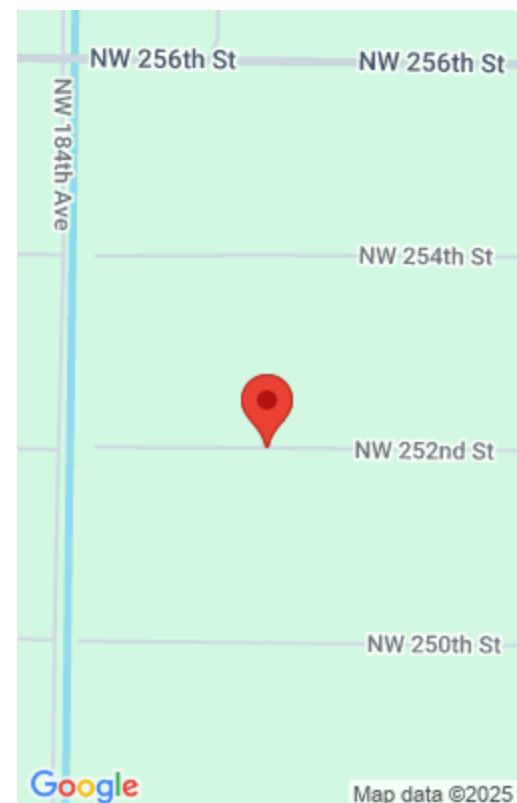

---

## Basics



**Listing updated:** May 27, 2025 at 8:07 pm  
**Status:** Active  
**Date added:** May 26, 2025 at 8:28 pm  
**For Sale:** No  
**Listing Office Name:** Friend Realty Inc

**Days on Comwire:** 14  
**Listing Office Id:** 500161  
**Est. Taxes:** \$539.17  
**For Lease:** No

---

## Site Details

**Lot SqFt:** 54450.00  
**Utilities On Site:** Electric,Well Water  
**Lot Description:** 1 to < 2 Acres  
**Ground Cover:** Grassed

**Improvements:** Cleared,Well  
**Front Exp:** Northwest  
**Roads:** County Road

---

## Building Details

**Type:** Agricultural  
**Docs Available:** Appraisal

---

## Additional Info

**Listing Agent Phone:** (772) 626-8271  
**MLS Source:** Realtor Association of the Palm Beaches (RAPB)

**Listing Office:** Friend Realty Inc

