



\$54,900

• Active

## 16916 NW 262ND ST, OKEECHOBEE, FL 34972, USA

<https://comwire.com>

Bring or build your dream home and barn onto this stunning, private 1.25-acre lot fully fenced with gates and culvert.

Okeechobee County offers a wealth of activities to enjoy. West of this location lies the Kissimmee River Preserve State Park, as well as the Kissimmee River itself, which leads into Lake Okeechobee, renowned for excellent

[+ Read More](#)

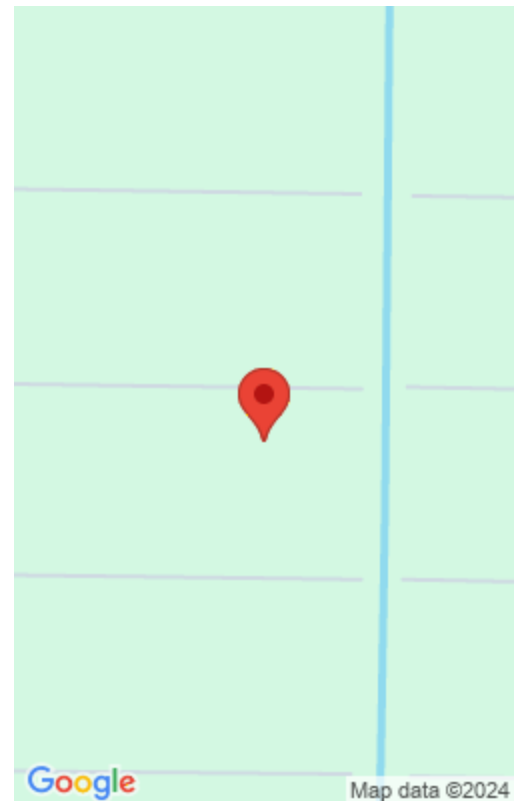

---

## Basics



**Status:** Active

**Date added:** Added 2 months ago

**For Sale:** No

**Listing Office Name:** American Realty of PSL LLC

**Listing Office Id:** 276736100

**Est. Taxes:** \$392.50

**For Lease:** No

---

## Site Details

**Lot SqFt:** 54450.00

**Utilities On Site:** None

**Lot Description:** 1 to < 2 Acres

**Ground Cover:** Other

**Improvements:** Cleared,Fenced

**Front Exp:** North

**Roads:** Dirt

---

## Building Details

**Type:** Single Family Detached

**Docs Available:** None

---

## Additional Info

**Listing Agent Phone:** (772) 200-5418

**Listing Office:** American Realty  
of PSL LLC

**MLS Source:** Realtor Association of the Palm Beaches (RAPB)

