



\$30,000

• Active

18232 276TH STREET, OKEECHOBEE, FL, 34972

<https://comwire.com>

1.25-acre lot in growing area, just a few miles from the Kissimmee Prairie Reserve. Zoned for both residential and agricultural use, offering a range of possibilities for your ideal property. Ideal for building your dream home, establishing plant nurseries, setting up fishing farms, creating private cemeteries, or starting a farm. Homes are close and on

[+ Read More](#)

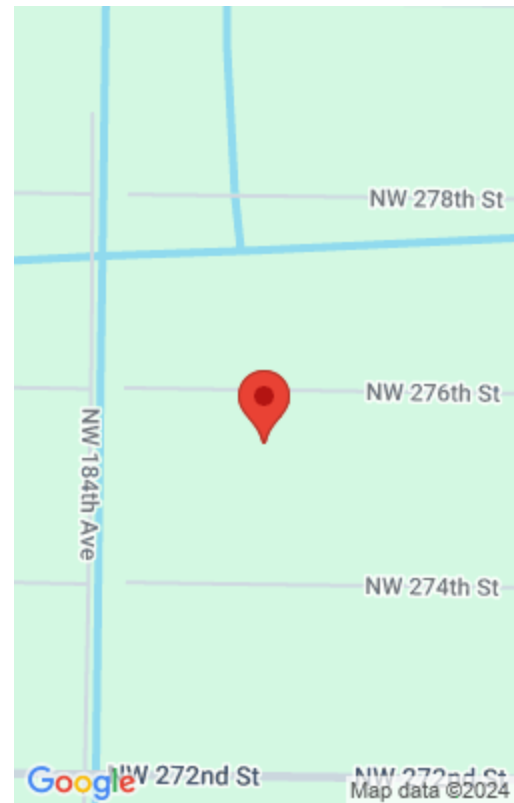

Basics



Status: Active
Date added: Added 2 weeks ago
Est. Taxes: \$400
For Sale: No
Listing Office Name: Realty ONE Group Innovation

Listing Office Id: 276547391
Lot size: 1.25 sq ft
Price/Acre: \$24,000
For Lease: No

Site Details

Acres: 1.25
Bldgs Include: Barns,Horse Stall
Utilities On Site: None
Front Exp: North
Roads: Country,Dirt,Highway,Other,Paved
Soil Type: Dirt

Lot SqFt: 54500.00
Improvements: None
Waterfrontage: NA
Lot Description: 1 to < 2 Acres
Ground Cover: Brush
HOA Fee/Month: \$0

Building Details

Type: Single Family Detached

Docs Available: None

Additional Info

Listing Agent Phone: (561) 403-0771

Agent Id: 276537892

Listing Office: Realty ONE Group Innovation

MLS Source: Realtor Association of the Palm Beaches (RAPB)

