



**18325 NW 278TH ST, OKEECHOBEE, FL
34972, USA**

<https://comwire.com>

Build or bring your dream home on this private 1.25-acre lot. Easy access to power in front of mobile home across from the dirt road. There is so much to enjoy in Okeechobee County. The Kissimmee River Preserve State Park West of this area as well is the Kissimmee River. The Kissimmee River flows into

[+ Read More](#)

\$54,900

• Active

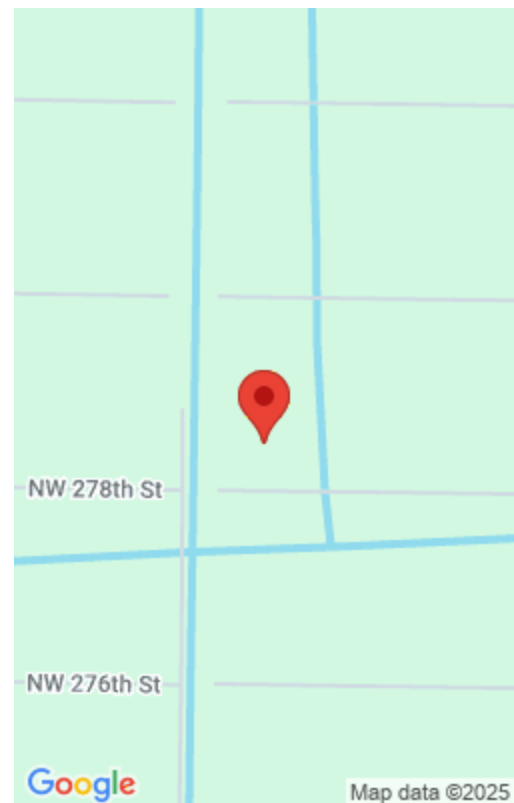

Basics



Comwire last checked: 3:03 am on June 09, 2025

Days on Comwire: 254

Listing Office Id: 276736100

Est. Taxes: \$375.40

For Lease: No

Listing updated: March 26, 2025 at 9:13 pm

Status: Active

Date added: September 28, 2024 at 1:33 pm

For Sale: No

Listing Office Name: American Realty of PSL LLC

Site Details

Lot SqFt: 54450.00

Utilities On Site: None

Lot Description: 1 to < 2 Acres

Ground Cover: Other

Improvements: None

Front Exp: South

Roads: Dirt

Building Details

Type: Single Family Detached

Docs Available: None

Additional Info

Listing Agent Phone: (772) 200-5418

Listing Office: American Realty of PSL LLC

MLS Source: Realtor Association of the Palm Beaches (RAPB)

