



\$39,000

• Active

18612 256TH ST, OKEECHOBEE, FL, 34972

<https://comwire.com>

DRY & HIGHLAND... 1.25 ACRES WITH GREAT ACCESS AND POWER ON TWO SIDES! Farm style living Beautiful property Low cost of living. Farm animals and raise your own garden. Mobile homes OK. Just 23 miles from Okeechobee Town and 27 miles from Okeechobee Lake. Okeechobee is one of the fastest growing towns in Midwest Florida.

[+ Read More](#)

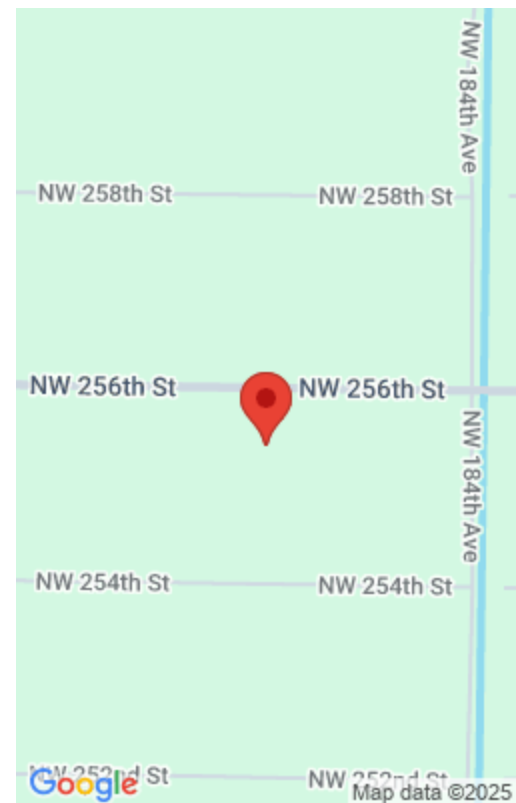

Basics



Comwire last checked: 2:27 pm on June 17, 2025

Days on Comwire: 258

Listing Office Id: 608170

Lot size: 1.25 sq ft

Price/Acre: \$31,200

For Lease: No

Listing updated: April 14, 2025 at 9:04 pm

Status: Active

Date added: October 02, 2024 at 11:41 pm

Est. Taxes: \$459.07

For Sale: No

Listing Office Name: Century 21 Tenace Realty

Site Details

Acres: 1.25

Improvements: None

Front Exp: North

Roads: Country

Lot SqFt: 54450.00

Utilities On Site: None

Lot Description: 1 to < 2 Acres

Ground Cover: Other

Building Details

Type: Single Family Detached

Docs Available: None

Additional Info

Listing Agent Phone: (561) 903-6074

Listing Office: Century 21 Tenace Realty

MLS Source: Realtor Association of the Palm Beaches (RAPB)

