



\$34,900

• Active

18619 248TH STREET, OKEECHOBEE, FL, 34972

<https://comwire.com>

Build your dream home or invest in your future with this beautiful 1.25-acre vacant lot located in the desirable Viking Estates / Prairie area of Okeechobee County right off the main paved road. This high and dry property offers plenty of space and flexibility, making it ideal for a single-family home, manufactured home, or weekend

[+ Read More](#)

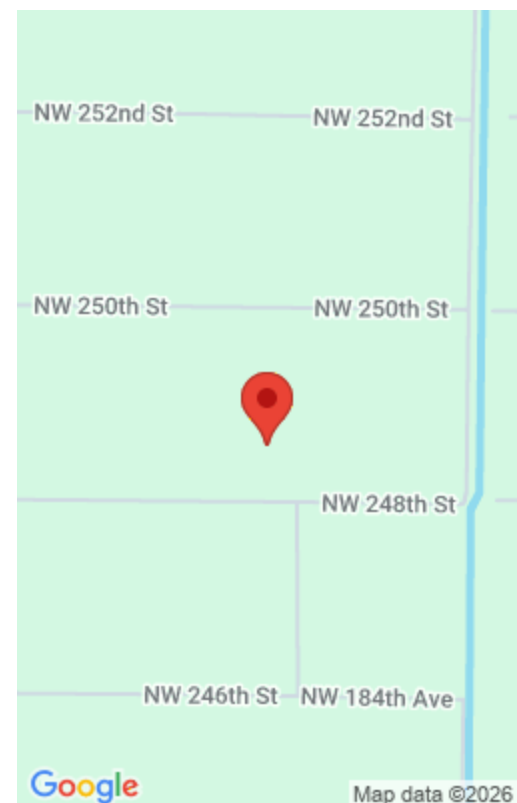

Basics



Comwire last checked: 12:22 pm on April 03, 2026

Listing updated: February 04, 2026 at 9:32 pm

Days on Comwire: 323

Status: Active

Listing Office Id: 276736100

Date added: August 21, 2025 at 2:43 pm

Est. Taxes: \$506.73

For Sale: No

For Lease: No

Listing Office Name: American Realty of PSL LLC

Site Details

Lot SqFt: 54450.00

Lot Dimensions: 165x322

Improvements: None

Utilities On Site: None

Front Exp: East

Lot Description: 1 to < 2 Acres

Roads: Dirt

Ground Cover: Other

Building Details

Type: Single Family Detached

Docs Available: None

Additional Info

Listing Agent Phone: (772) 200-5418

Listing Office: American Realty of PSL LLC

MLS Source: Realtor Association of the Palm Beaches (RAPB)

