



\$32,000

• Active

## 18781 270TH STREET, OKEECHOBEE, FL, 34972

<https://comwire.com>

Are you looking for serene privacy? Come build your dream home on this beautiful 1.25 corner acre lot! The Kissimmee River Preserve State Park West of this area as well is the Kissimmee River. The Kissimmee River flows into Lake Okeechobee and is well known for some of the best fishing. whether you like Fishing,

[+ Read More](#)

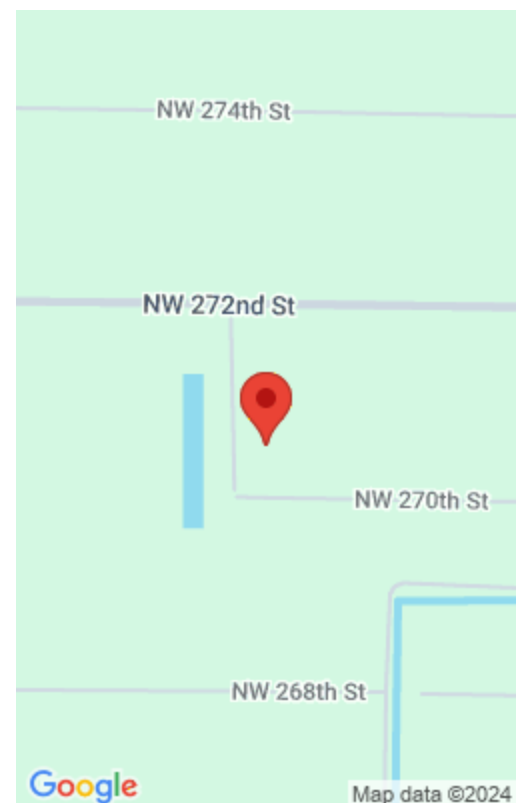

---

## Basics



**Status:** Active

**Date added:** Added 3 days ago

**For Sale:** No

**Listing Office Name:** Dalton Wade Inc

**Listing Office Id:** 260031661

**Est. Taxes:** \$346.75

**For Lease:** No

---

## Site Details

**Lot SqFt:** 54450.00

**Utilities On Site:** None

**Lot Description:** 1 to < 2 Acres,Corner Lot

**Ground Cover:** Brush,Grassed

**Improvements:** None

**Front Exp:** South

**Roads:** Dirt

---

## Building Details

**Type:** Single Family Detached

**Docs Available:** None

---

## Additional Info

**Listing Agent Phone:** (863) 634-3023 **Agent Id:** 276667822

**Listing Office:** Dalton Wade Inc

**MLS Source:** Realtor Association of the Palm Beaches (RAPB)

