



\$29,000

• Active

18824 242ND STREET, OKEECHOBEE, FL, 34972

<https://comwire.com>

Discover the perfect 1.25-acre property in Okeechobee County to build or bring your dream home and barn. This partly cleared lot features a culvert and gate, offering both privacy and convenience, as it's located just off the main paved road. Power Poles on the street making accessing power a breeze. Enjoy the best of Florida

[+ Read More](#)

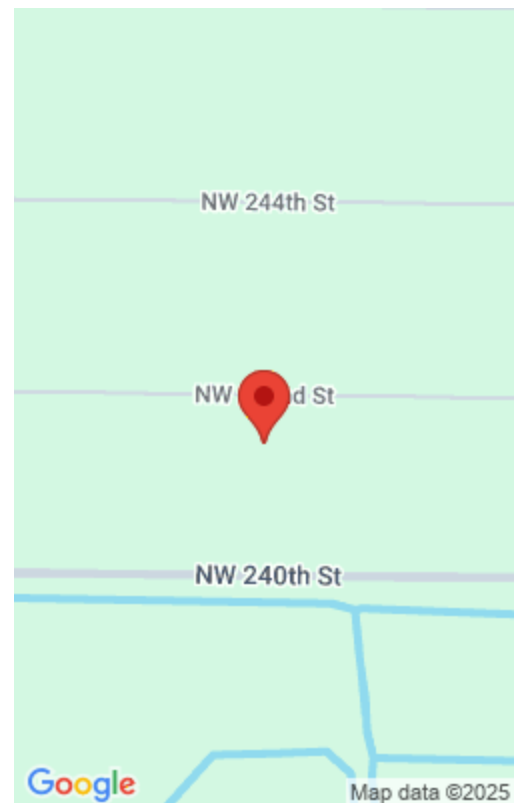

Basics



Comwire last checked: 9:48 am on April 22, 2025

Days on Comwire: 5

Listing Office Id: 276736100

Lot size: 1.25 sq ft

Price/Acre: \$23,200

For Lease: No

Listing updated: April 19, 2025 at 3:50 pm

Status: Active

Date added: April 18, 2025 at 5:06 pm

Est. Taxes: \$489.20

For Sale: No

Listing Office Name: American Realty of PSL LLC

Site Details

Acres: 1.25

Lot Dimensions: 165X301

Utilities On Site: None

Lot Description: 1 to < 2 Acres

Ground Cover: Other

Lot SqFt: 54450.00

Improvements: None

Front Exp: North

Roads: Dirt

Building Details

Type: Single Family Detached

Docs Available: None

Additional Info

Listing Agent Phone: (772) 200-5418

Listing Office: American Realty of PSL LLC

MLS Source: Realtor Association of the Palm Beaches (RAPB)

