



\$85,000

• Active

**18935 268TH STREET, OKEECHOBEE, FL,
34972**

<https://comwire.com>

Rare opportunity in Okeechobee! Two adjoining parcels being sold together as one expansive 2.5-acre homesite. Conveniently located just off Peavine Trail, a main paved road, this property offers easy access while maintaining a peaceful, rural setting. Approximately 1.50 acres have already been cleared, saving you time and money. Property features an installed culvert and fenced

[+ Read More](#)

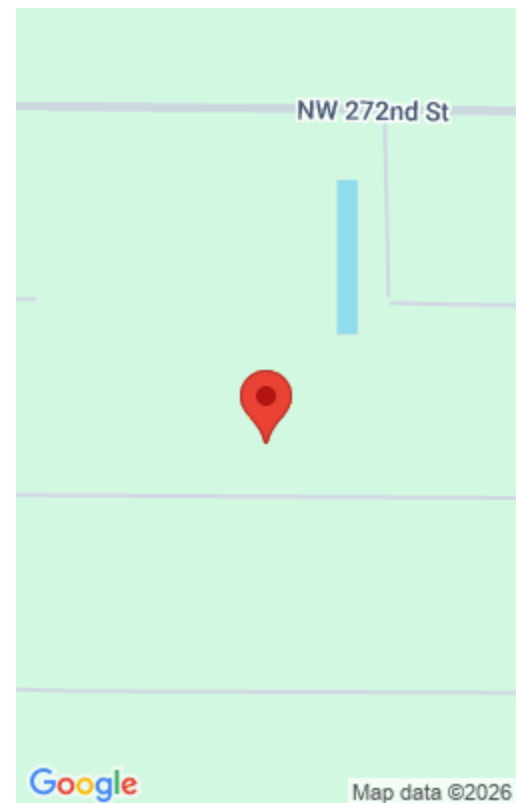

Basics



Listing updated: February 26, 2026 at 7:07 pm

Status: Active

Date added: February 25, 2026 at 4:12 pm

HOA Dues \$: \$164

Price/Acre: \$34,000

For Lease: No

Days on Comwire: 133

Listing Office Id: 276736100

Lot size: 2.50 sq ft

Est. Taxes: \$488.12

For Sale: No

Listing Office Name: American Realty of PSL LLC

Site Details

Acres: 2.50

Lot Frontage: 164.00

Improvements: Fenced,Cleared

Front Exp: North

Roads: Dirt

Lot SqFt: 108900.00

Lot Dimensions: 164x602

Utilities On Site: None

Lot Description: 1 to < 2 Acres,2 to < 3 Acres

Ground Cover: Other

Building Details

Type: Single Family Detached

Docs Available: None

Additional Info

Listing Agent Phone: (772) 200-5418

Listing Office: American Realty of PSL LLC

MLS Source: Realtor Association of the Palm Beaches (RAPB)

