



\$45,000

• Active

## 19094 NW 284TH ST, OKEECHOBEE, FL 34972, USA

<https://comwire.com>

1.5 Acre lot, Partially Cleared in Center, 3rd Lot from paved rd. New Culvert & 25' Driveway. Fully Fenced with Two 10' Gates. Property has several mature Oak trees, Palm trees and Maples. Single family homes, double wide mobile homes of 1000sqft or larger are permitted. (Barndominiums may be permitted Please Verify this before purchase).

[+ Read More](#)

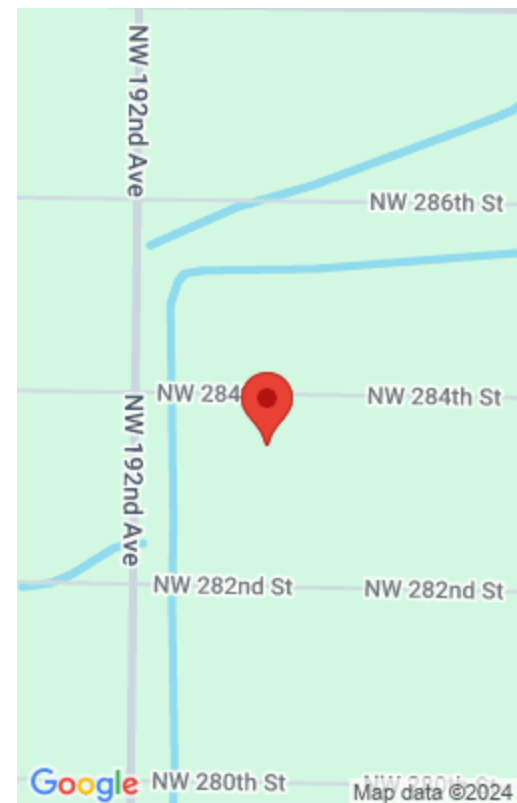

---

## Basics



**Status:** Active

**Date added:** Added 1 month ago

**For Sale:** No

**Listing Office Name:** Partnership Realty Inc.

**Listing Office Id:** 404692

**Est. Taxes:** \$505

**For Lease:** No

---

## Site Details

**Improvements:** Cleared,Fenced

**Front Exp:** North

**Roads:** County Road

**Utilities On Site:** None

**Lot Description:** 1 to < 2 Acres

**Ground Cover:** Brush,Grassed

---

## Building Details

**Type:** Single Family Detached

**Docs Available:** None

---

## Additional Info

**Listing Agent Phone:** (772) 206-6779

**Listing Office:** Partnership  
Realty Inc.

**MLS Source:** Realtor Association of the Palm Beaches (RAPB)

