



\$49,999

• Active

19374 302, OKEECHOBEE, FL, 34972

<https://comwire.com>

Build or bring your mobile and barn to this spacious 1.25-acre lot just off the main dirt road, offering both privacy and easy access. The property is already cleared, fully fenced, and equipped with a gate and culvert, with power poles on the street making it simple to connect to electricity. Enjoy the best

[+ Read More](#)

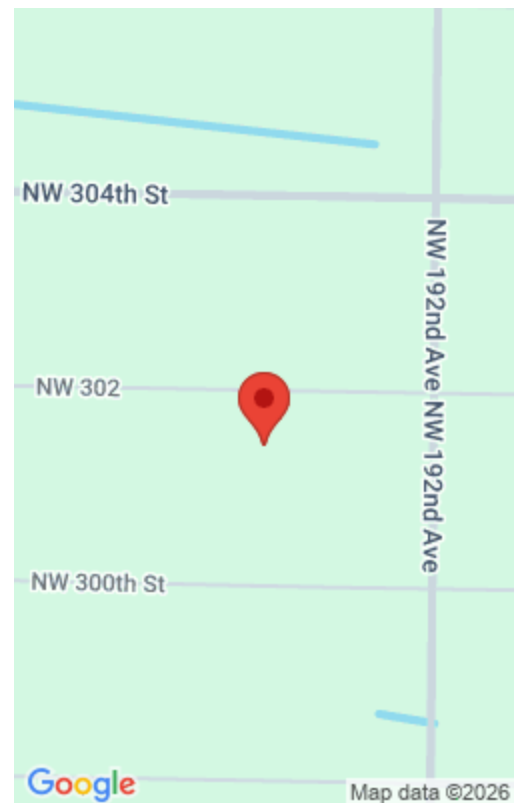

Basics



Comwire last checked: 12:22 pm on April 03, 2026 **Listing updated:** February 04, 2026 at 9:10 pm

Days on Comwire: 324

Status: Active

Listing Office Id: 276736100

Date added: August 21, 2025 at 6:32 am

HOA Dues \$: \$165

Est. Taxes: \$401.68

For Sale: No

For Lease: No

Listing Office Name: American Realty of PSL LLC

Site Details

Lot SqFt: 54450.00

Lot Frontage: 165.00

Lot Dimensions: 165x301

Improvements: Fenced

Utilities On Site: None

Front Exp: East

Lot Description: 1 to < 2 Acres

Roads: Dirt

Ground Cover: Other

Building Details

Type: Single Family Detached

Docs Available: Survey

Additional Info

Listing Agent Phone: (772) 200-5418

Listing Office: American Realty of PSL LLC

MLS Source: Realtor Association of the Palm Beaches (RAPB)

