



**\$78,000**

• Active

## **19833 280TH STREET, OKEECHOBEE, FL, 34972**

<https://comwire.com>

ONE OF A KIND lot for sale ...Existing Electric with 200 amp service includes an RV receptacle! RARE as it's no longer permitted without house permit. High & Dry 1.25 acres Several improvements. Driveway & culvert, Land is cleared leaving select large Palm & Oak trees. Livestock fence around the perimeter. Water well & water softener.

[+ Read More](#)

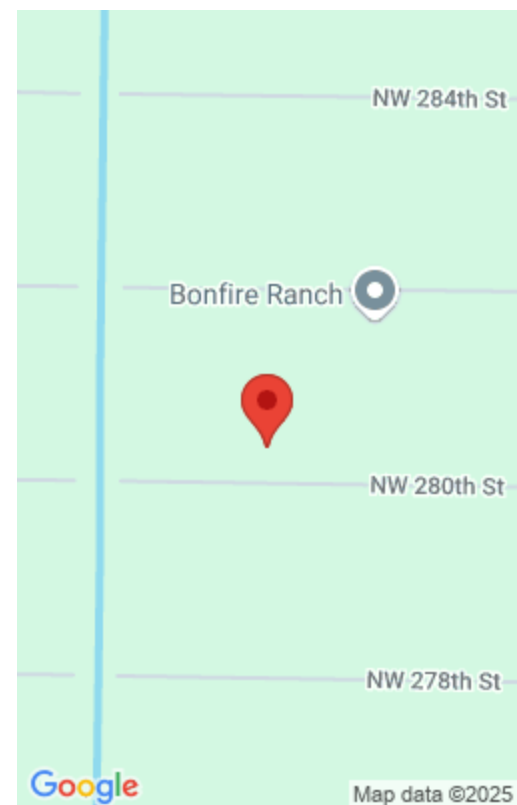

---

## **Basics**



**Listing updated:** March 31, 2025 at 8:14 pm

**Status:** Active

**Date added:** March 15, 2025 at 6:57 pm

**Est. Taxes:** \$1,583.92

**For Sale:** No

**Listing Office Name:** Illustrated Properties LLC (Co

**Days on Comwire:** 37

**Listing Office Id:** 400100

**Lot size:** 1.25 sq ft

**Price/Acre:** \$62,400

**For Lease:** No

## Site Details

**Acres:** 1.25

**Improvements:** Fenced,Cleared,Well

**Front Exp:** South

**Roads:** Dirt

**Lot SqFt:** 54450.00

**Utilities On Site:** Electric,Well Water

**Lot Description:** 1 to < 2 Acres

**Ground Cover:** Grassed

## Building Details

**Type:** Single Family Detached

**Docs Available:** None

## Additional Info

**Listing Agent Phone:** (512) 461-9039

**MLS Source:** Realtor Association of the Palm Beaches (RAPB)

**Listing Office:** Illustrated Properties LLC (Co

