



\$27,000

• Active

**19989 NW 280TH ST, OKEECHOBEE, FL
34972, USA**

<https://comwire.com>

Discover the perfect opportunity to build your dream home , modular , or mobile on this secluded 1.25 acre lot . Located at the end of a quite road , this property offers easy access to power with poles already on the street . Experience all that Okeechobee County has to offer , including the

[+ Read More](#)

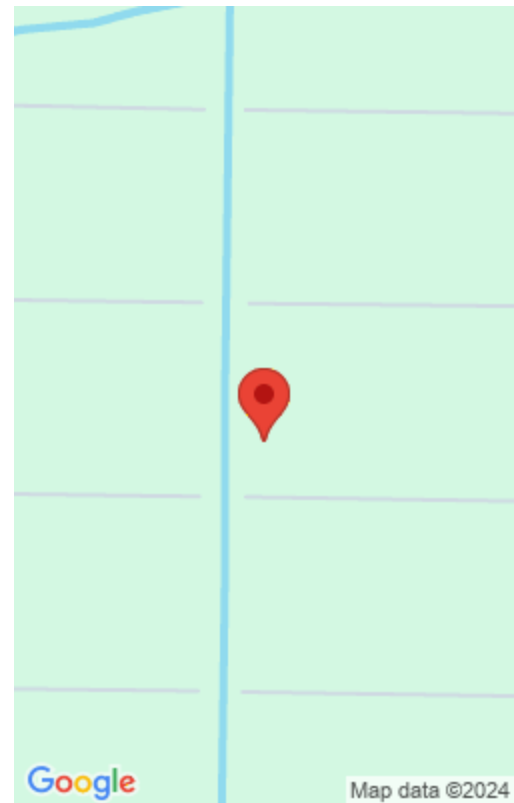

Basics



Status: Active

Date added: Added 2 months ago

For Sale: No

Listing Office Name: Keller Williams Realty of PSL

Listing Office Id: 802428

Est. Taxes: \$359.08

For Lease: No

Site Details

Lot SqFt: 54450.00

Utilities On Site: None

Lot Description: 1 to < 2 Acres

Ground Cover: Other

Improvements: None

Front Exp: South

Roads: Dirt

Building Details

Type: Agricultural

Docs Available: None

Additional Info

Listing Agent Phone: (786) 804-0340

Listing Office: Keller Williams
Realty of PSL

MLS Source: Realtor Association of the Palm Beaches (RAPB)

