



\$300,000

• Active

205 11TH STREET, OKEECHOBEE, FL, 34972

<https://comwire.com>

Great potential !!! .90 acres with 212 ft frontage and depth 150ft. CURRENTLY ZONED(RMF) RESIDENTIAL MULTIPLE FAMILY and with future land use- LOTS 7-10, COMMERCIAL and lot 11 SINGLE FAMILY RESIDENTIAL **. paved road. NO HOA **

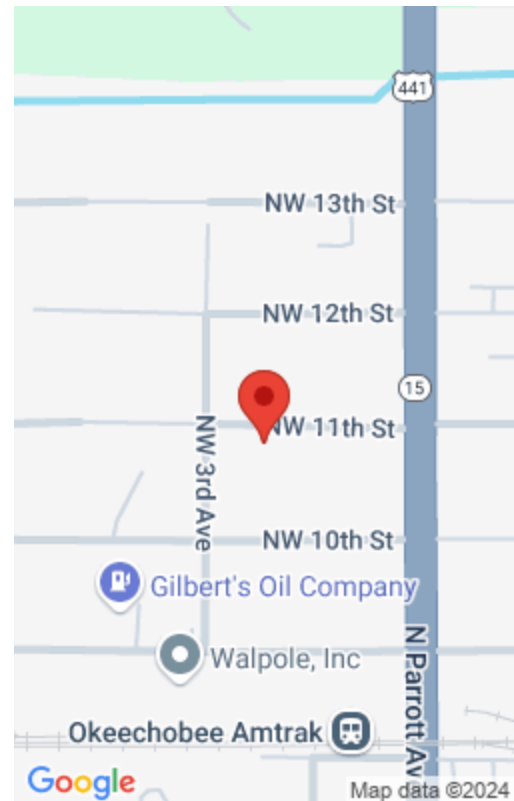

Basics



Status: Active

Date added: Added 7 days ago

For Sale: No

Listing Office Name: RE/MAX Select Group

Listing Office Id: 276699914

Est. Taxes: \$1,283.40

For Lease: No

Site Details

Lot SqFt: 39300.00

Improvements: Cleared,Street Light

Front Exp: South

Roads: City/County Maint.

Lot Dimensions: 212.0 ft x 150.0 ft

Utilities On Site: None

Lot Description: 1/2 to < 1 Acre,1/4 to 1/2 Acre

Ground Cover: Brush,Other

Building Details

Type: Commercial Land

Docs Available: None

Additional Info

Listing Agent Phone: (561) 255-0776 **Agent Id:** 641591218

Listing Office: RE/MAX Select Group **MLS Source:** Realtor Association of the Palm Beaches (RAPB)

