

22240 282ND STREET, OKEECHOBEE, FL, 34972

<https://comwire.com>

Build or bring your dream home and barn on this beautiful private 1.5 acre. There is so much to enjoy in Okeechobee County. The Kissimmee River Preserve State Park West of this area as well is the Kissimmee River. The Kissimmee River flows into Lake Okeechobee and is well known for some of the best

[+ Read More](#)

\$24,900

• Active

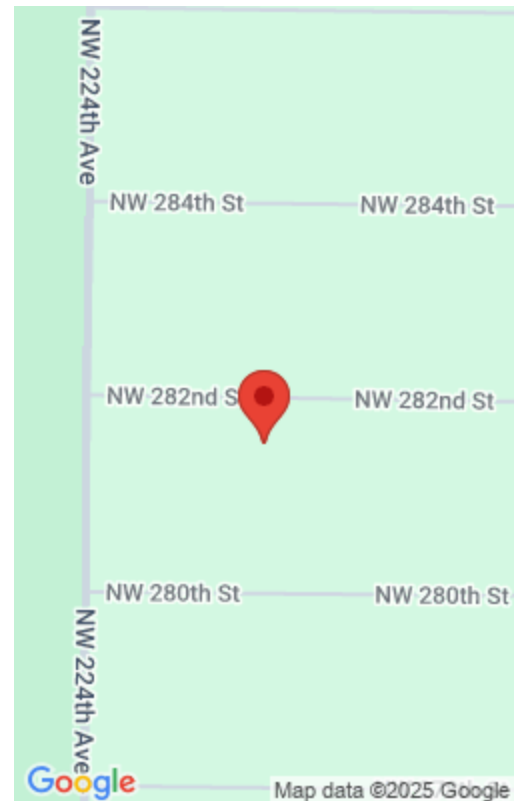

Basics



Comwire last checked: 9:48 am on April 22, 2025

Days on Comwire: 6

Listing Office Id: 276736100

Lot size: 1.50 sq ft

Price/Acre: \$16,600

For Lease: No

Listing updated: April 19, 2025 at 8:08 pm

Status: Active

Date added: April 18, 2025 at 2:28 pm

Est. Taxes: \$444.99

For Sale: No

Listing Office Name: American Realty of PSL LLC

Site Details

Acres: 1.50

Lot Dimensions: 187x303

Utilities On Site: None

Lot Description: 1 to < 2 Acres

Ground Cover: Other

Lot SqFt: 65340.00

Improvements: None

Front Exp: North

Roads: Dirt

Building Details

Type: Single Family Detached

Docs Available: None

Additional Info

Listing Agent Phone: (772) 200-5418

Listing Office: American Realty of PSL LLC

MLS Source: Realtor Association of the Palm Beaches (RAPB)

