



\$1,749,990

• Active

2321 SNEED ROAD, FORT PIERCE, FL, 34945

<https://comwire.com>

Do not miss out on this 51-acre tract on Sneed Road. This fully fenced, high & dry property offers the tranquility of a private retreat with the convenience of being just minutes from I-95, the FL Turnpike, beaches, and historic downtown. With well, zoned Ag-5, No HOA and no restrictions, the possibilities are endless.

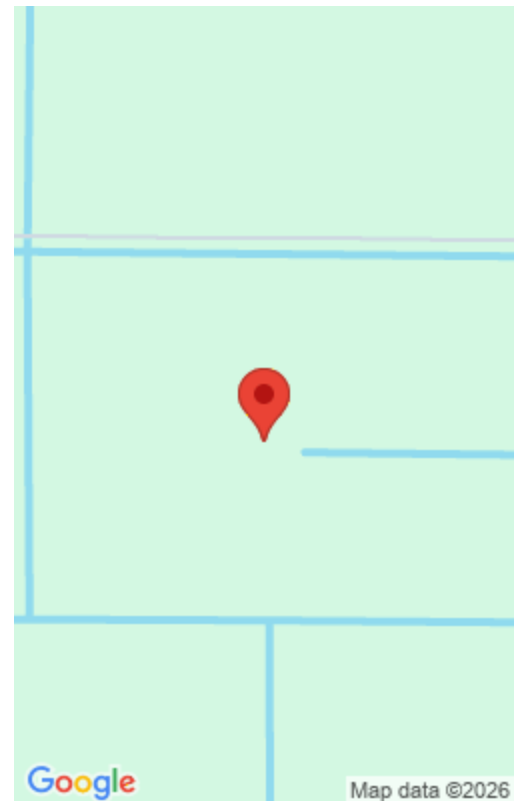

Basics



Listing updated: February 04, 2026 at 10:46 am

Days on Comwire: 174

Status: Active

Listing Office Id: 276736100

Date added: January 17, 2026 at 8:53 pm

Lot size: 51.37 sq ft

HOA Dues \$: \$1,313

Est. Taxes: \$1,765.04

Price/Acre: \$34,066.38

For Sale: No

For Lease: No

Listing Office Name: American Realty of PSL LLC

Site Details

Acres: 51.37

Lot SqFt: 2237677.00

Lot Frontage: 1313.00

Lot Dimensions: 1313x1708x1322x1698

Improvements: Fenced

Utilities On Site: None

Front Exp: North

Lot Description: 50+ Acres

Roads: Dirt

Ground Cover: Other

Building Details

Type: Single Family Detached

Docs Available: None

Additional Info

Listing Agent Phone: (772) 200-5418

Listing Office: American Realty of PSL LLC

MLS Source: Realtor Association of the Palm Beaches (RAPB)

