



\$229,900

• Active

13169 SE 26TH LN, OKEECHOBEE, FL 34974, USA

<https://comwire.com>

5 +/- Acres in Bridlewood Gated Community. Fully Cleared & High and Dry makes this the perfect canvas for your dream home or equestrian estate. With ample space and excellent accessibility, it offers the best of rural living with modern conveniences just minutes away. Located in the equestrian-friendly neighborhood, perfect for horse lovers. Paved road access and

[+ Read More](#)

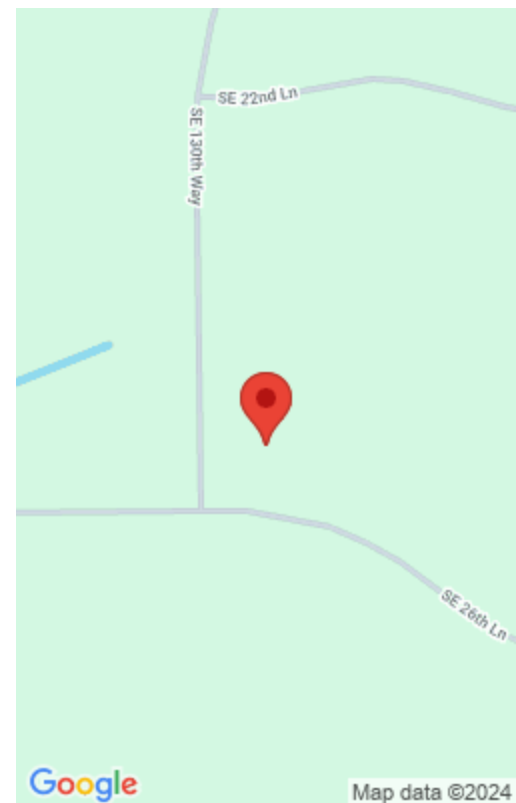

Basics



Status: Active

Date added: Added 1 month ago

Est. Taxes: \$1,545.28

For Sale: No

Listing Office Name: Mixon Real Estate Group

Listing Office Id: 1037462

Lot size: 5.18 sq ft

Price/Acre: \$44,382.24

For Lease: No

Site Details

Acres: 5.18

Improvements: Cleared

Front Exp: South

Roads: County Road,Paved

HOA Fee/Month: \$125

Lot SqFt: 225641.00

Utilities On Site: None

Lot Description: 5 to 10 Acres

Ground Cover: Grassed

Building Details

Type: Single Family Detached

Docs Available: None

Additional Info

Listing Agent Phone: (863) 801-5239

Listing Office: Mixon Real Estate Group

MLS Source: Realtor Association of the Palm Beaches (RAPB)

