

Lot Dimensions
are Estimates



\$29,900

• Active

36619 NW 8TH TER, OKEECHOBEE, FL 34972, USA

<https://comwire.com>

Discover Your Slice of Paradise: Secluded Country Living Awaits! Welcome to your dream retreat nestled conveniently off Highway 441, where nature and tranquility converge! This stunning property offers an exceptional opportunity for those seeking a peaceful lifestyle surrounded by abundant wildlife, including graceful deer, majestic wild turkeys, and even the elusive Florida panthers. Imagine waking

[+ Read More](#)

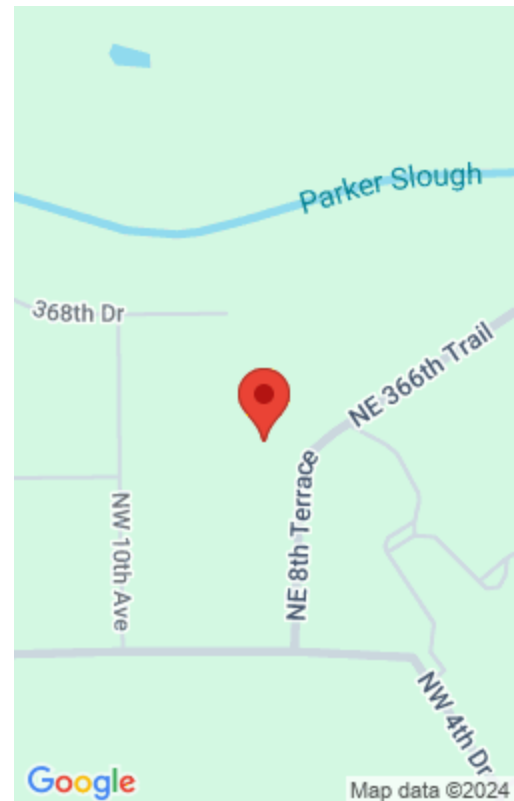

Basics



Status: Active

Date added: Added 1 month ago

Est. Taxes: \$354.17

For Sale: No

Listing Office Name: Dalton Wade Inc

Listing Office Id: 260031661

Lot size: 1.09 sq ft

Price/Acre: \$27,431.19

For Lease: No

Site Details

Acres: 1.09

Improvements: None

Front Exp: East

Lot Description: 1 to < 2 Acres,Paved Road,Public Road,Treed Lot

Ground Cover: Brush,Other

Special Info: Foreign Seller,Platted

Lot SqFt: 47480.00

Utilities On Site: None

View: Garden,Preserve

Roads: City/County Maint.,Country,County Road,Paved

Soil Type: Dirt

Building Details

Type: Single Family Detached

Docs Available: None

Additional Info

Listing Agent Phone: (772) 284-4511

Listing Office: Dalton Wade Inc

MLS Source: Realtor Association of the Palm Beaches (RAPB)

