

1:1,128

Map Title

\$25,000

• Active

1465 NW 52ND CT, OCALA, FL 34482, USA

<https://comwire.com>

Ocala Ridge lot available in Marion County Florida. No HOA. Short drive to World Equestrian Center. Buy and build or hold for investment.

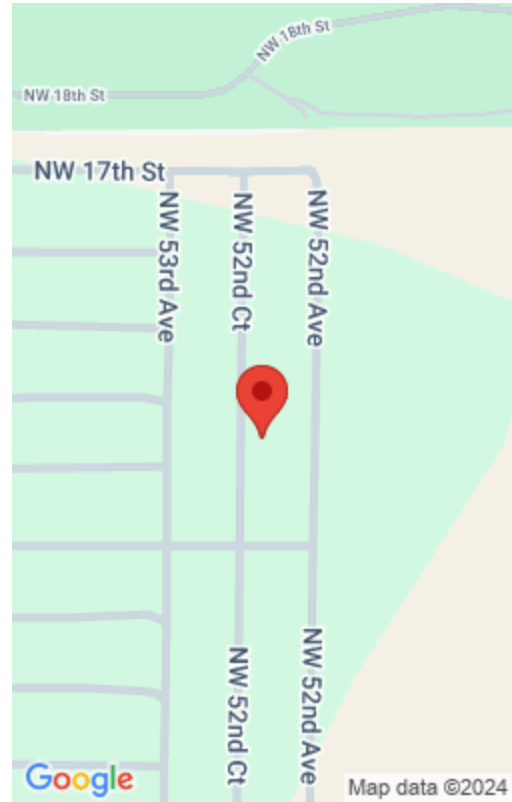

Basics



Status: Active
Date added: Added 2 months ago
HOA Dues \$: \$75
Price/Acre: \$147,058.82
For Lease: No

Listing Office Id: 955382
Lot size: 0.17 sq ft
Est. Taxes: \$93.23
For Sale: No
Listing Office Name: Real Estate of Florida

Site Details

Acres: 0.17
Lot Frontage: 75.00
Improvements: None
Front Exp: West
Roads: Dirt

Lot SqFt: 7405.00
Lot Dimensions: 75x100
Utilities On Site: None
Lot Description: < 1/4 Acre
Ground Cover: Brush

Building Details

Type: Single Family Detached

Docs Available: Aerial

Additional Info

Listing Agent Phone: (561) 756-4736

Listing Office: Real Estate of Florida

MLS Source: Realtor Association of the Palm Beaches (RAPB)

