



\$549,000

• Active

TBD KELLY ROAD, FORT PIERCE, FL, 34945

<https://comwire.com>

There are 3 lots available at this price + 4 more at different prices. See BROCHURE for complete details. Each lot has road frontage. AG-5 zoning allows 1 home + 1 guest house on each lot. There is no similar inventory in the county. Select your lot now!

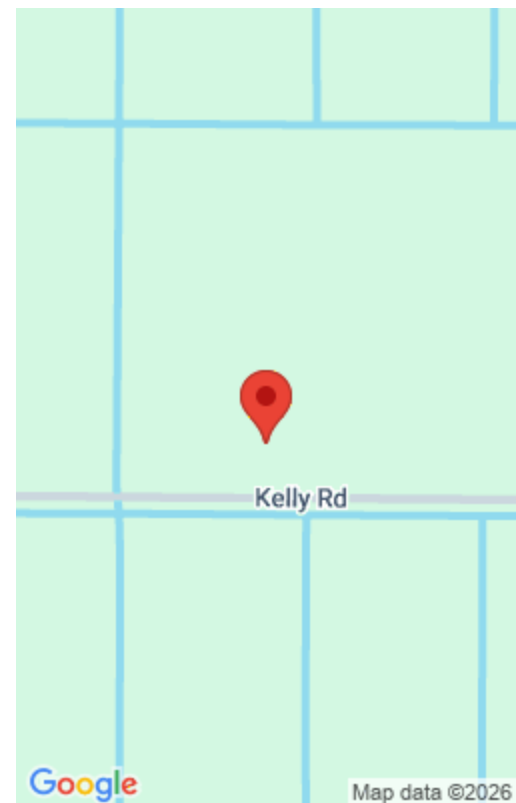

Basics



Listing updated: March 03, 2026 at 7:30 pm **Days on Comwire:** 127
Status: Active **Listing Office Id:** 276533466
Date added: March 03, 2026 at 3:26 pm **Lot size:** 9.30 sq ft
HOA Dues \$: \$324 **Est. Taxes:** \$277
Price/Acre: \$59,032.26 **For Sale:** No
For Lease: No **Listing Office Name:** Mark Walters & Company

Site Details

Acres: 9.30 **Lot Frontage:** 324.00
Improvements: Cleared,Drainage,Pasture **Utilities On Site:** None
Front Exp: South **Lot Description:** 5 to 10 Acres,Dirt Road,West of US-1
Roads: County Road,Dirt **Ground Cover:** Grassed,Weeds
Special Info: Agricultural Exempt

Building Details

Type: Agricultural **Docs Available:** Aerial,Plat Maps,Survey

Additional Info

Listing Agent Phone: (772) 201-5650 **Listing Office:** Mark Walters & Company
MLS Source: Realtor Association of the Palm Beaches (RAPB)

