



\$20,000

• Active

### 76VWGXQ4+M2

<https://comwire.com>

This 1.25-acre Lot, accessible via dirt roads. This property is located off an access road that may be difficult for non off-road vehicles to drive on. Embrace a serene country lifestyle and ride your side by side. Backs up to the Kissimmee Prairie Preserve

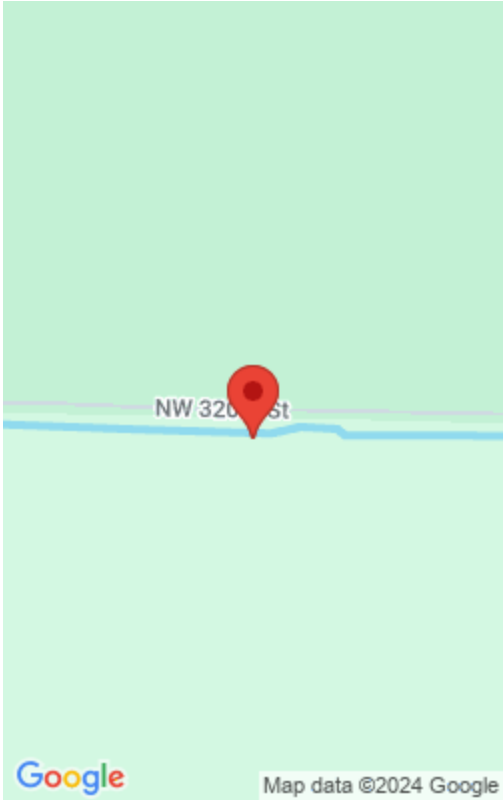

---

## Basics



**Status:** Active

**Date added:** Added 2 months ago

**Est. Taxes:** \$167.28

**For Sale:** No

**Listing Office Name:** Florida Real Estate Navigators

**Listing Office Id:** 276668226

**Lot size:** 1.25 sq ft

**Price/Acre:** \$16,000

**For Lease:** No

---

## Site Details

**Acres:** 1.25

**Lot Dimensions:** 165x297

**Utilities On Site:** None

**Lot Description:** 1 to < 2 Acres

**Ground Cover:** Other,Palmetto

**Lot SqFt:** 54450.00

**Improvements:** Cleared

**Front Exp:** North

**Roads:** County Road,Dirt

---

## Building Details

**Type:** Single Family Detached

**Docs Available:** None

---

## Additional Info

**Listing Agent Phone:** (772) 579-3383

**Agent Id:** 276671722

**Listing Office:** Florida Real Estate Navigators

**MLS Source:** Realtor Association of the Palm Beaches (RAPB)

