



\$2,510,000

• Active

UNASSIGNED, FELLSMERE, FL, 32948

<https://comwire.com>

2.51-acre industrial parcel Possible Owner Financing offers a rare and unbeatable opportunity in a rapidly growing commercial hub! Positioned right on Route 512, this property boasts exceptional visibility and accessibility, making it perfect for businesses looking to establish or expand in a high-traffic, high-growth area. Just 2 miles from I-95 providing quick access to major

[+ Read More](#)

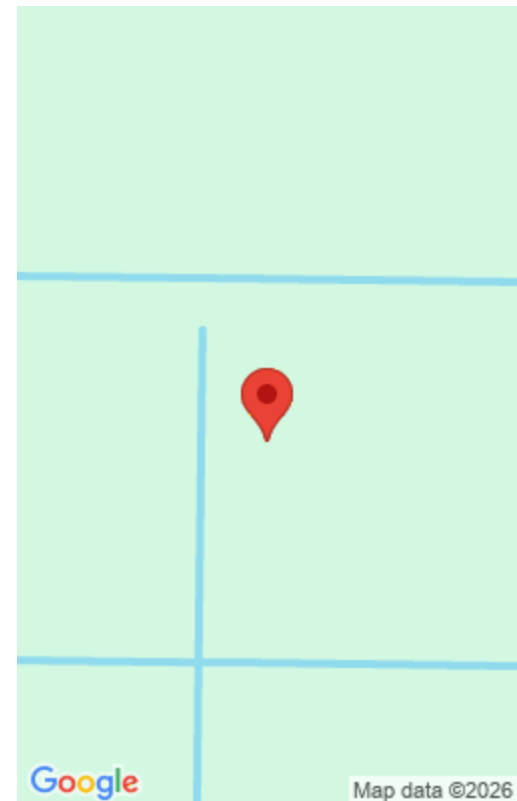

Basics



Comwire last checked: 12:22 pm on April 03, 2026

Days on Comwire: 333

Listing Office Id: 955352

Lot size: 2.51 sq ft

Price/Acre: \$1,000,000

For Lease: No

Listing updated: February 23, 2026 at 7:47 pm

Status: Active

Date added: June 16, 2025 at 12:14 pm

Est. Taxes: \$1,849

For Sale: No

Listing Office Name: Billero & Billero Properties

Site Details

Acres: 2.51

Utilities On Site: Cable,Electric,Public Water

View: Other

Roads: City/County Maint.,Paved

Improvements: None

Front Exp: South

Lot Description: 2 to < 3 Acres

Ground Cover: Other

Building Details

Type: Industrial Land

Docs Available: Survey

Additional Info

Listing Agent Phone: (772) 473-4206

Listing Office: Billero & Billero Properties

MLS Source: Realtor Association of the Palm Beaches (RAPB)

